



Whitley Court, Whitley Court, Coventry CV3 4AH
Offers In The Region Of £121,950

archerbassett
LETTINGS AND SALES

- IDEAL FIRST TIME PURCHASE -STAMP DUTY EXEMPT FOR FIRST TIME BUYERS - NO UPWARD CHAIN
- TWO DOUBLE BEDROOMS
- SPACIOUS LOUNGE / DINER
- FITTED KITCHEN TO INCLUDE FITTED OVEN & HOB, WASHING MACHINE & FRIDGE FREEZER
- GARAGE
- LONG LEASE OF 127 YEARS & ANNUAL GROUND RENT OF £10 FIXED UNTIL 2062 & PEPPERCORN RENT THERE AFTER
- GAS CENTRAL HEATED WITH WORCESTER BOSCH BOILER
- STYLISH BATHROOM
- TO INCLUDE GOOD QUALITY CARPETS FITTED THROUGHOUT
- ENERGY RATING C

IDEAL FIRST TIME PURCHASE - NO CHAIN - LONG LEASE. This well presented and spacious two bedroom top floor flat has double glazing & gas central heating throughout. In brief the flat comprises of a good size lounge/diner with a large southerly facing window, a modern fitted kitchen with a range of wall & base units and integrated oven & hob. Both of the bedrooms are double in size with the principal bedroom having a fitted wardrobe and the fully tiled bathroom has a white suite to include a bath with power shower over. Externally there is off road parking available, a garage and well kept communal gardens.

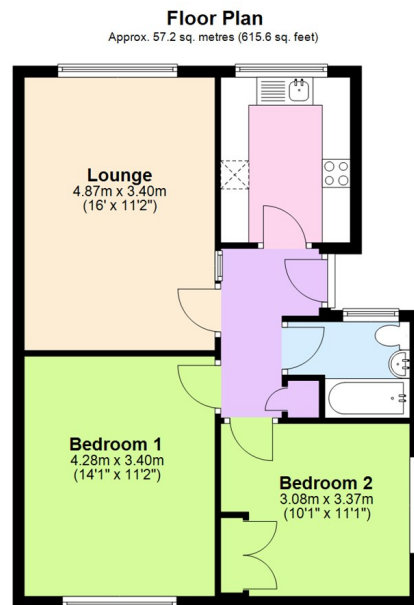

Total area: approx. 57.2 sq. metres (615.6 sq. feet)

This plan is for illustrative and guidance purposes only and should be used as such by any prospective purchaser. Whilst every attempt has been made to ensure the accuracy of this floor plan all measurements of rooms, windows, doors and any other items are approximate and no responsibility is taken by the Agent for any errors, omissions or misrepresentation.
Plan produced using PlanUp.

