

The Avenue, Acocks Green, Birmingham B27 6NS
£199,950

archerbassett
LETTINGS AND SALES

- CURRENTLY ACHEIVING RENTAL INCOME OF £11,940PA
- PRIVTAE GARDEN
- UPSTAIRS BATHROOM
- GAS CENTRAL HEATING
- ANNUAL RENTAL YIELD OF 5.9%
- SPACIOUS AND MODERN
- TWO DOUBLE BEDROOMS
- DOUBLE GLAZING
- REAR GARDEN

**** CURRENTLY ACHEIVING RENTAL INCOME OF £11,940PA **** A well presented two bedroom mid-terraced home which is well situated close to Birmingham Airport and not far from Solihull Hospital. Briefly comprising of entrance porch, spacious lounge with feature box window, a good sized fitted kitchen/diner with a range of white wall and base units. To the first floor there is two generously sized double bedrooms and a part tiled family bathroom with white suite to include a bath with mixer shower over, w/c and hand wash basin. Other benefits include double glazing, gas central heating and a sizable rear garden with lawn, patio area and a number of out buildings.

Ground Floor
Approx. 29.8 sq. metres (321.2 sq. feet)

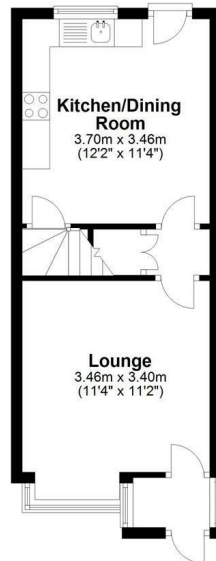

First Floor
Approx. 32.8 sq. metres (353.3 sq. feet)

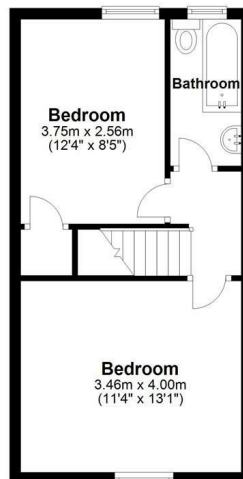

Total area: approx. 62.7 sq. metres (674.5 sq. feet)

This floor plan is for illustration purposes only, this is not intended to be a measured/scaled survey or comply with RICS guidelines. All measurements (including total floor area) openings, orientation and floor area are approximate. No details are guaranteed, they cannot be relied upon for any purpose and do not form part of any agreement. A party must rely upon its own inspection(s). No responsibility is taken for any error, omission, or mis-statement.
Plan produced using PlanUp.

