



Signals Drive, The Heights, New Stoke Village CV3 1PA  
£149,950

**archerbassett**  
LETTINGS AND SALES



- EXCELLENT FIRST TIME PURCHASE OR INVESTMENT
- OPEN PLAN LIVING
- TWO DOUBLE BEDROOMS
- SECURE PHONE ENTRY
- ALLOCATED PARKING
- GOOD TRANSPORT LINKS
- EN SUITE

**\*\* IDEAL FIRST TIME PURCHASE OR INVESTMENT \*\* MODERN AND LIGHT \*\*** A superbly presented two double bedroom apartment based in the popular New Stoke Village estate, close to local amenities, transport links and only 10 minutes from University Hospital Coventry and Warwickshire. Briefly comprising of a spacious open plan lounge/kitchen with a range of wall and base units and integrated oven and gas hob. The main bedroom benefits from an en-suite with shower cubicle and the main bathroom features a white suite with bath, W/C and hand wash basin. Additional benefits include double glazing and central heating throughout, further storage in the hallway, an allocated parking space, secure entry phone and well kept communal areas.

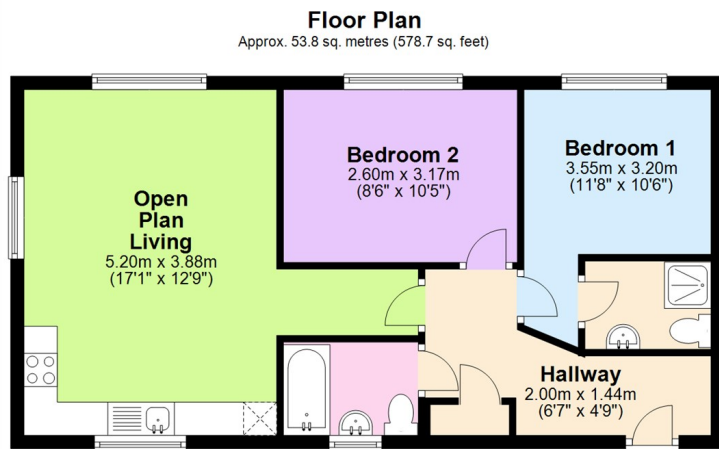

Total area: approx. 53.8 sq. metres (578.7 sq. feet)

This plan is for illustrative and guidance purposes only and should be used as such by any prospective purchaser. Whilst every attempt has been made to ensure the accuracy of this floor plan all measurements of rooms, windows, doors and any other items are approximate and no responsibility is taken by the Agent for any errors, omissions or misrepresentation.  
Plan produced using PlanUp.

